



KIARO EASY



OPENING
SYSTEMS FOR
LIFT UP AND
DROP DOWN
DOORS



OPENING SYSTEMS
FOR LIFT UP AND DROP
DOWN DOORS

KIARO EASY

ITALIANA
ferramenta

KIARO EASY



AVAILABLE FINISHES

Anthracite (EE)

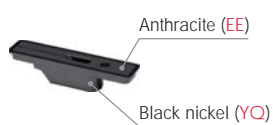

Brown 8019 (LD)

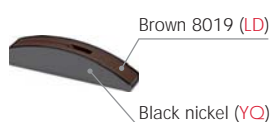
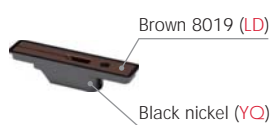

Grey 9007 (EW)



White (AB)

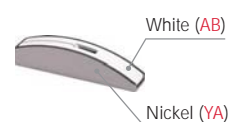
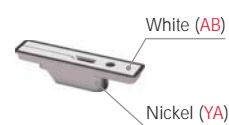



KIARO EASY SINGLE INSTALLATION

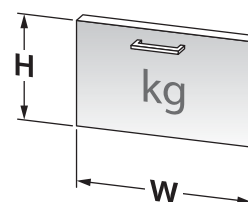
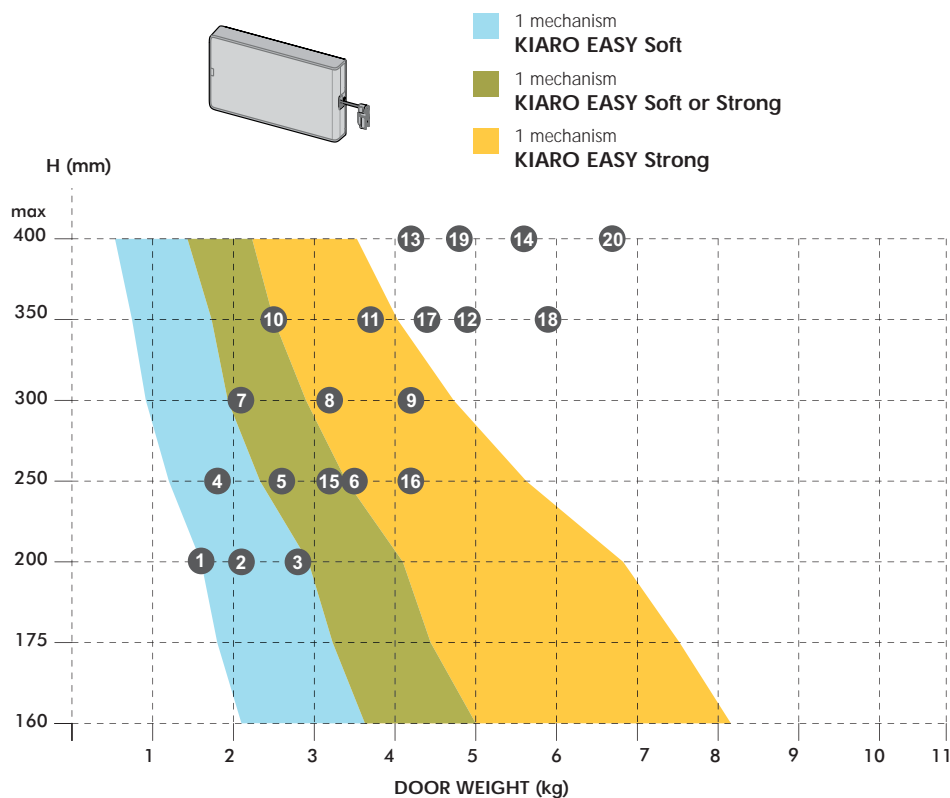

Door weight including the possible handle.

KIARO EASY DOUBLE INSTALLATION

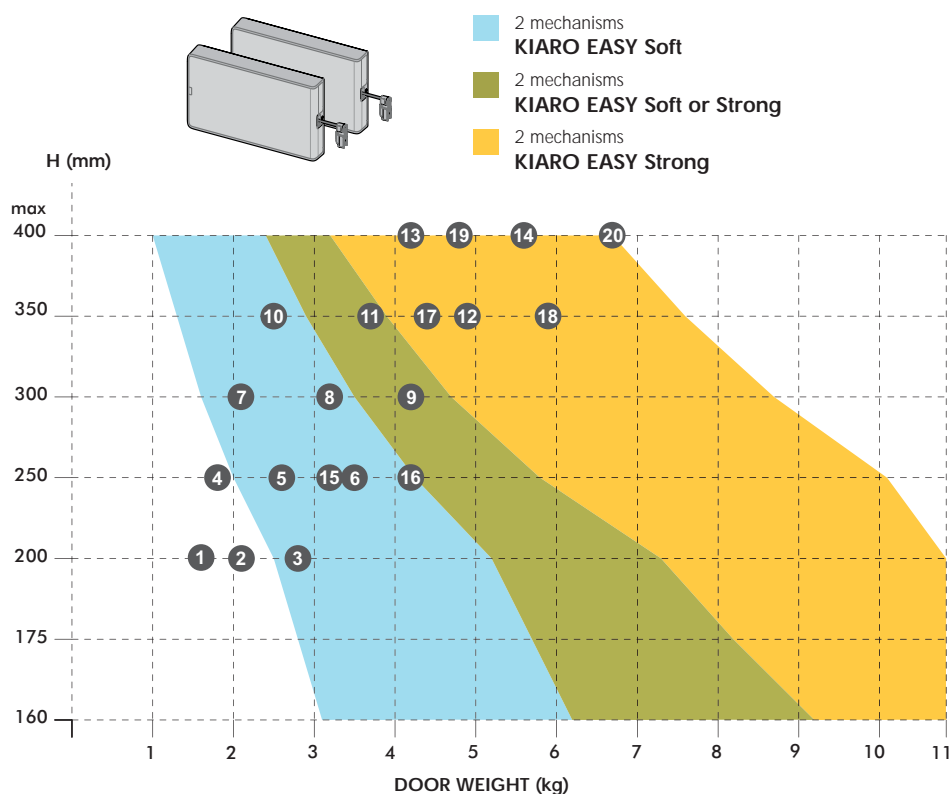

		H mm	W mm	Weight theoretical
1	Chipboard door thk 18mm	200	600	1,6 kg
2	Chipboard door thk 18mm	200	900	2,1 kg
3	Chipboard door thk 18mm	200	1200	2,8 kg
4	Chipboard door thk 18mm	250	600	1,8 kg
5	Chipboard door thk 18mm	250	900	2,6 kg
6	Chipboard door thk 18mm	250	1200	3,5 kg
7	Chipboard door thk 18mm	300	600	2,1 kg
8	Chipboard door thk 18mm	300	900	3,2 kg
9	Chipboard door thk 18mm	300	1200	4,2 kg
10	Chipboard door thk 18mm	350	600	2,5 kg
11	Chipboard door thk 18mm	350	900	3,7 kg
12	Chipboard door thk 18mm	350	1200	4,9 kg
13	Chipboard door thk 18mm	400	900	4,2 kg
14	Chipboard door thk 18mm	400	1200	5,6 kg
15	MDF door thk 18mm	250	900	3,2 kg
16	MDF door thk 18mm	250	1200	4,2 kg
17	MDF door thk 18mm	350	900	4,4 kg
18	MDF door thk 18mm	350	1200	5,9 kg
19	MDF door thk 18mm	400	900	4,8 kg
20	MDF door thk 18mm	400	1200	6,7 kg

Weight considering: Chipboard 650 kg/m³ and
MDF 780 kg/m³.

These are experimental results to be checked by the customer.

In accordance with the actual European regulation, we suggest where possible to use two KIARO EASY mechanisms for each door.
Our technical department is at your disposal to analyze further cases out of this chart.



UNHANDED MECHANISM

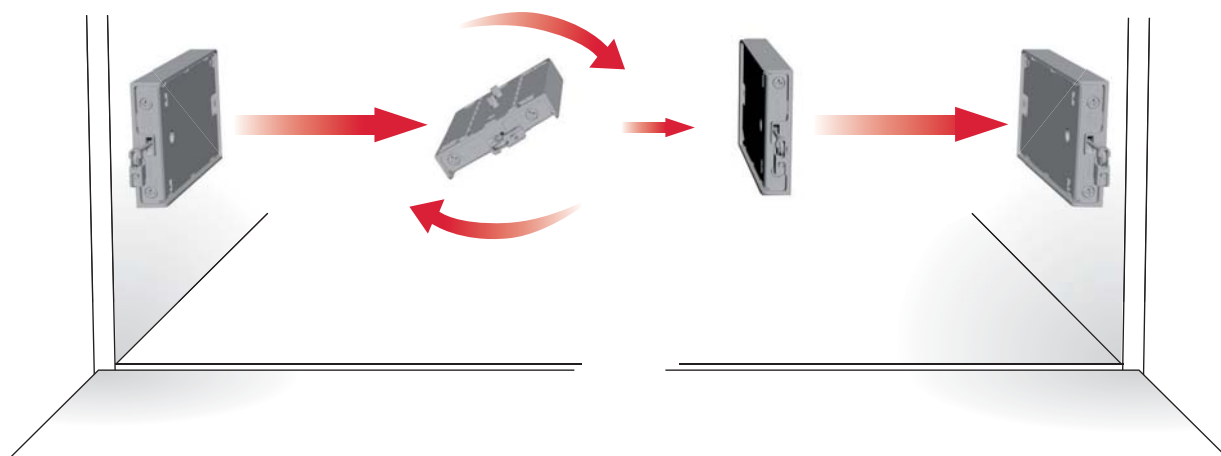

MECHANISM AND DOOR BRACKET INSTALLATION

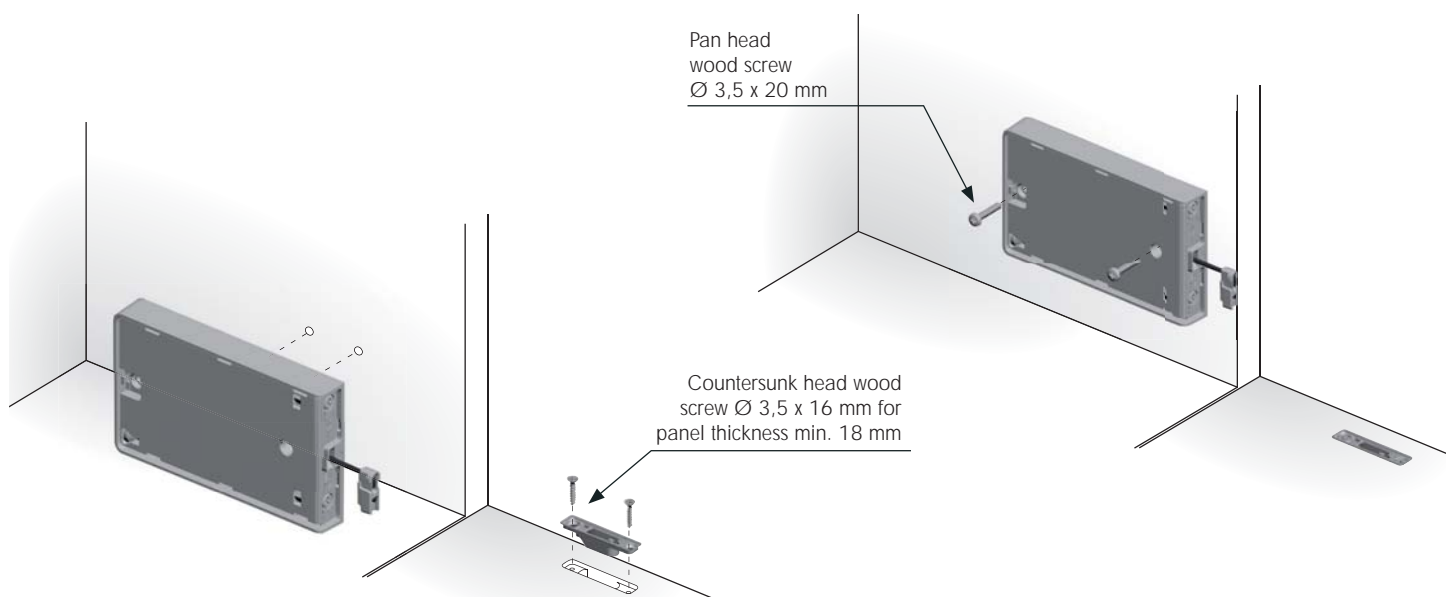

WIRE INSERTION ONTO THE DOOR BRACKET

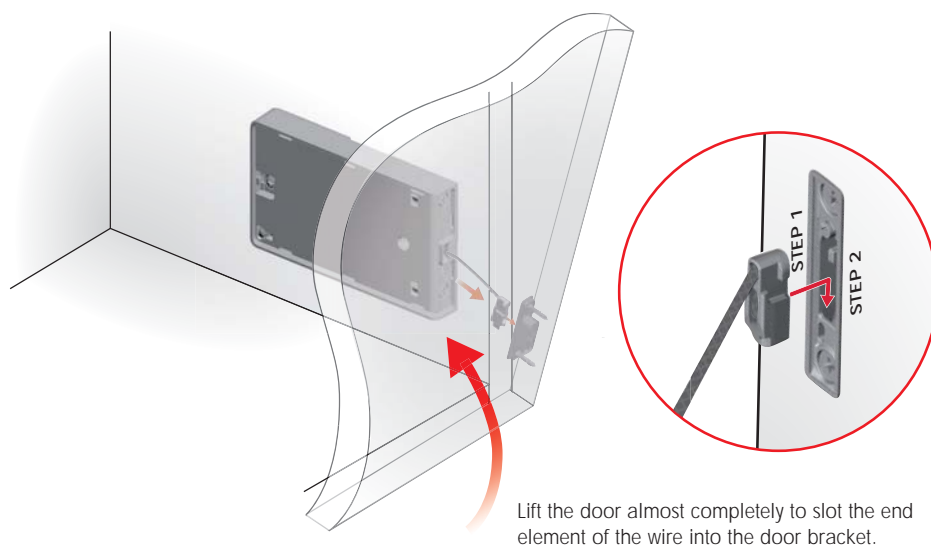

STEP 1



STEP 2



click



DOOR BRACKET COVER CAP INSERTION

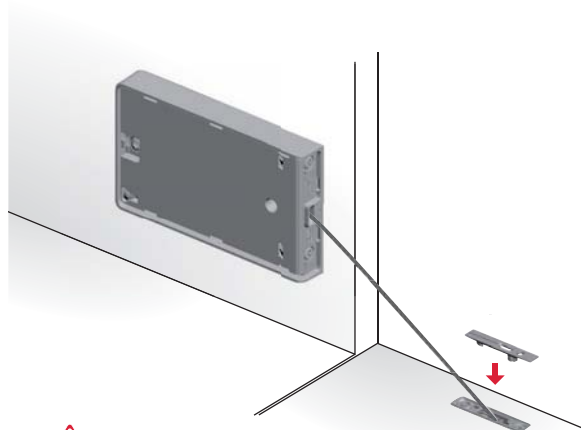

Place the cover cap on the door bracket before lifting the door.

OPENING ANGLE ADJUSTMENT

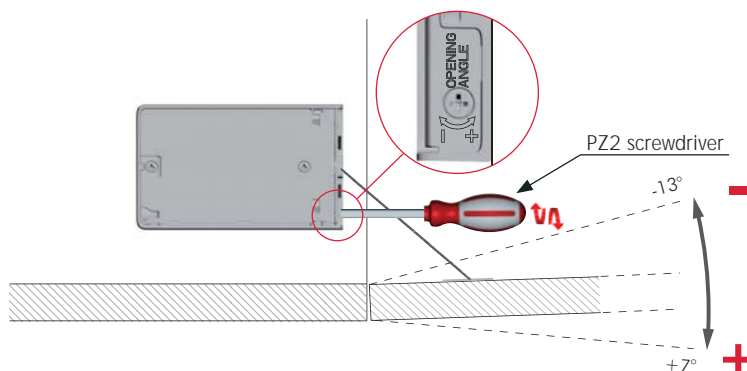

The adjustment of door opening angle must be carried out before the power adjustment.

POWER ADJUSTMENT

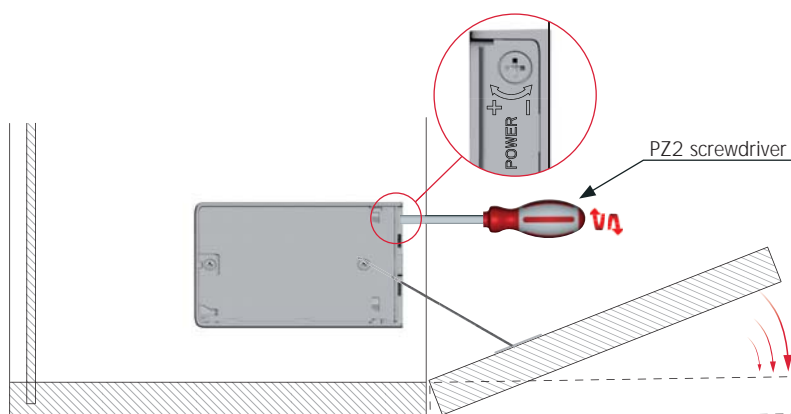

Power +

The slowing phase of door opening is anticipated.

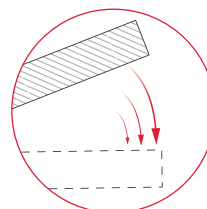

Power -

The slowing phase of door opening is delayed.

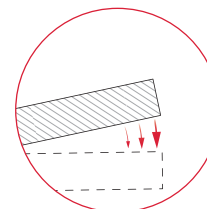

MECHANISM COVER INSERTION

STEP 1

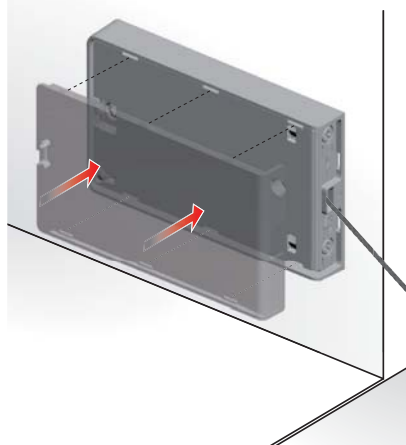

STEP 2

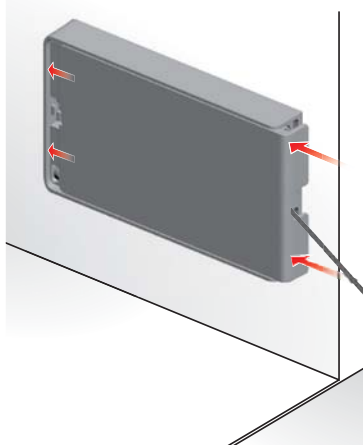

MECHANISM COVER REMOVAL

Use a blade screwdriver to unlock the cover and proceed with showed removal steps.

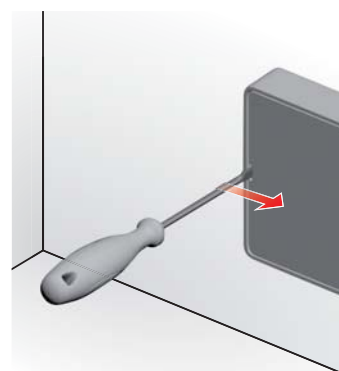

REMOVAL STEP 1

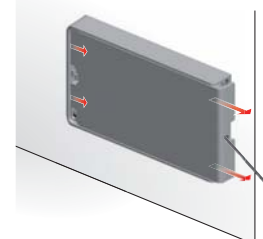

REMOVAL STEP 2

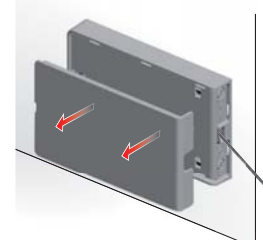



KIARO EASY WITH KIMANA HINGE

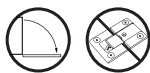

SIDE PANEL DRILLING PLAN WITH EMBEDDED DOOR BRACKET

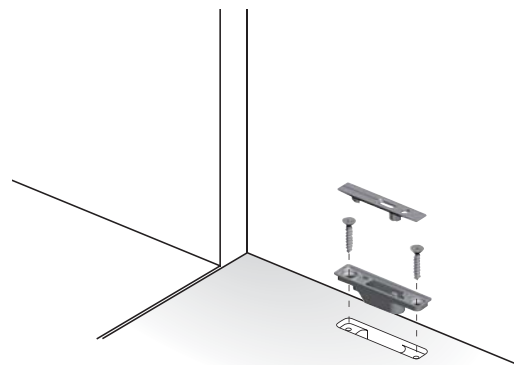
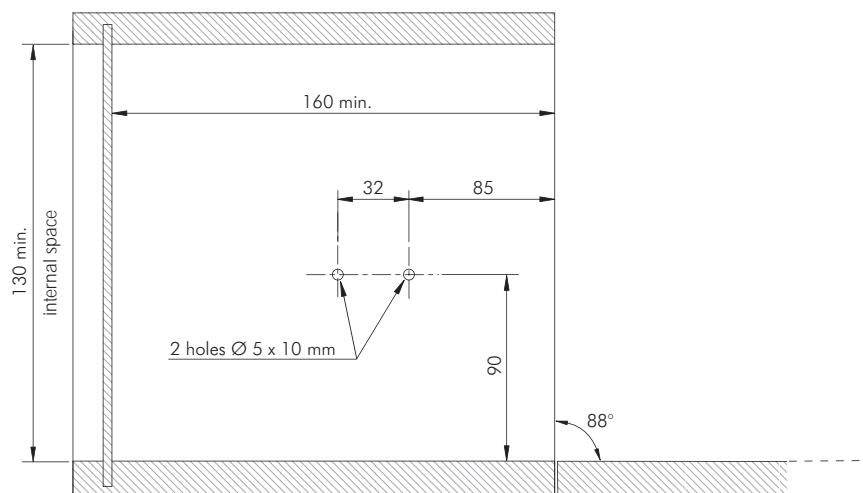

Overcrossing 90° door opening angle, negatively affects the Kimana hinges.

SIDE PANEL DRILLING PLAN WITH SCREW FIXING DOOR BRACKET

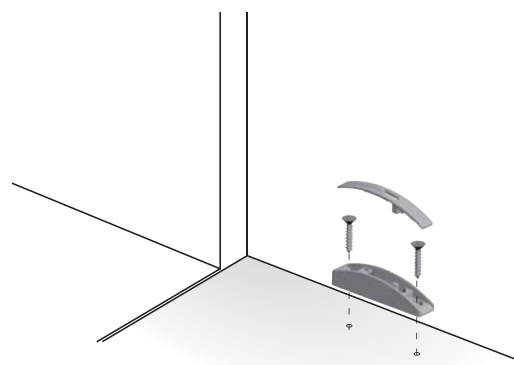
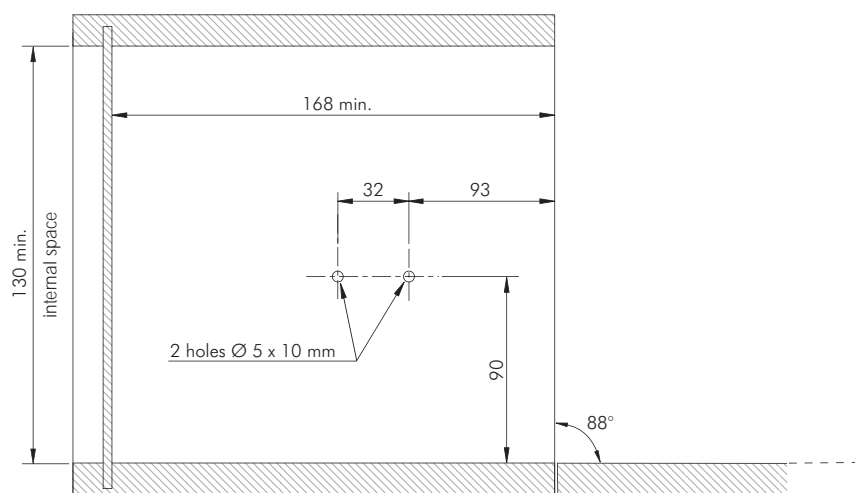

Overcrossing 90° door opening angle, negatively affects the Kimana hinges.



In case of door without handles it is recommended to use **K Push Tech with buffer**.

KIARO EASY WITH STANDARD UNSPRUNG HINGES



In case the hinges to be installed are not KIMANA hinges, please contact our technical department to receive the correct drilling plan. It is necessary to indicate all the values requested in the following diagram:

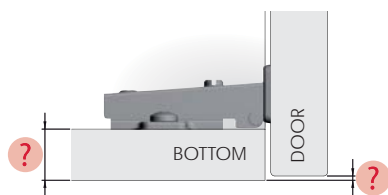

CLOSING CONDITION

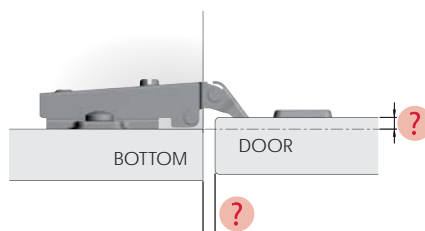

OPENING CONDITION



KIARO EASY MECHANISM

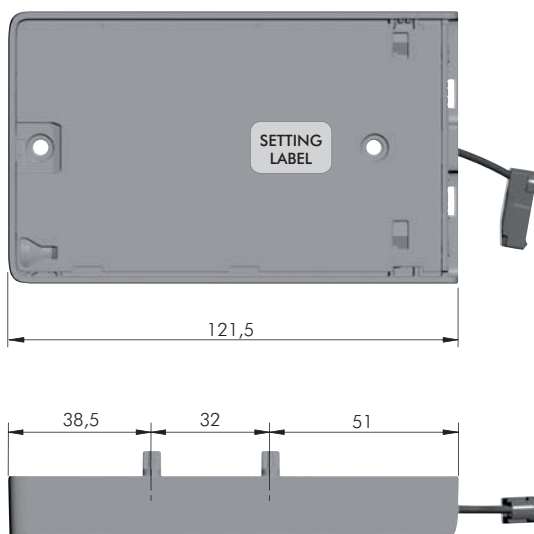
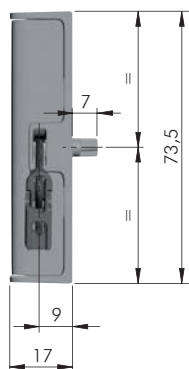





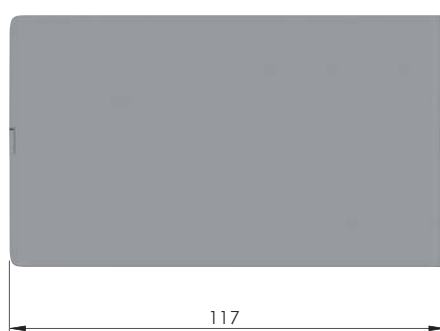
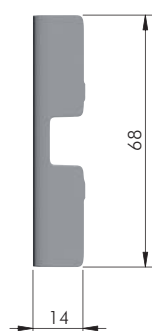

ZA	EP	ST	= 20 pcs.	
49504000EE	EW	LD	AB	Soft
49506000EE	EW	LD	AB	Strong



KIARO EASY COVER



EP	 = 20 pcs.			
				
49502000EE	EW	LD	AB	





EMBEDDED DOOR BRACKET

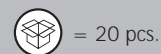
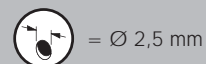
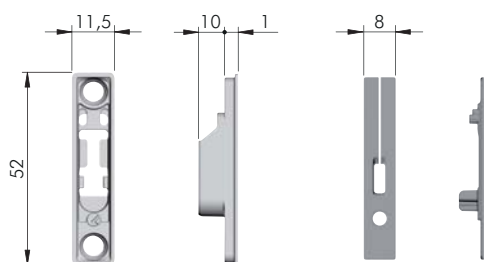

49503000YQ

EE

YQ

49503000YA

EW

YA

49503010YQ

LD

YQ

49503010YA

AB

YA

DOOR PANEL DRILLING OPERATIONS

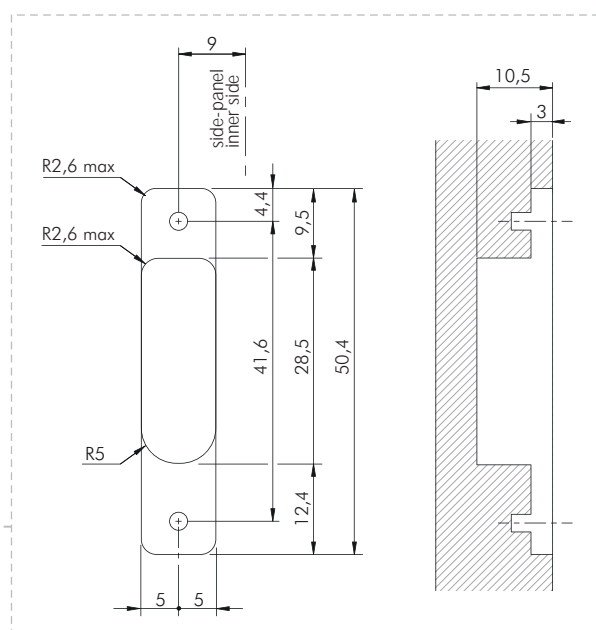
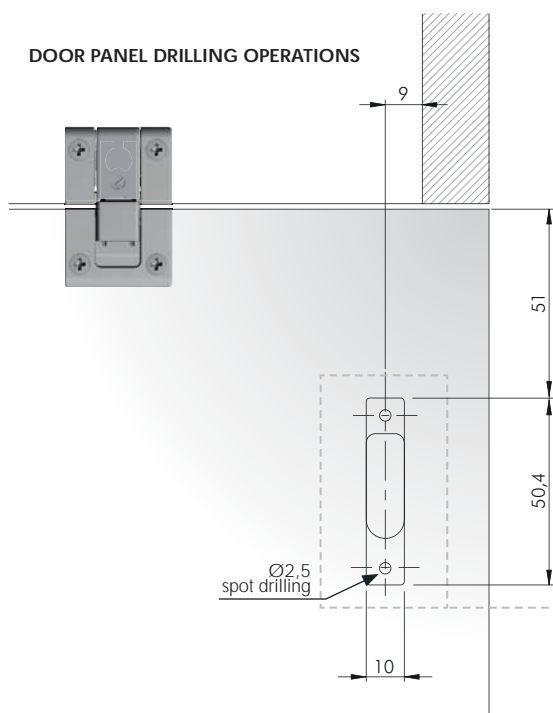

SCREW FIXING DOOR BRACKET

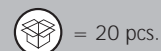
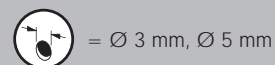
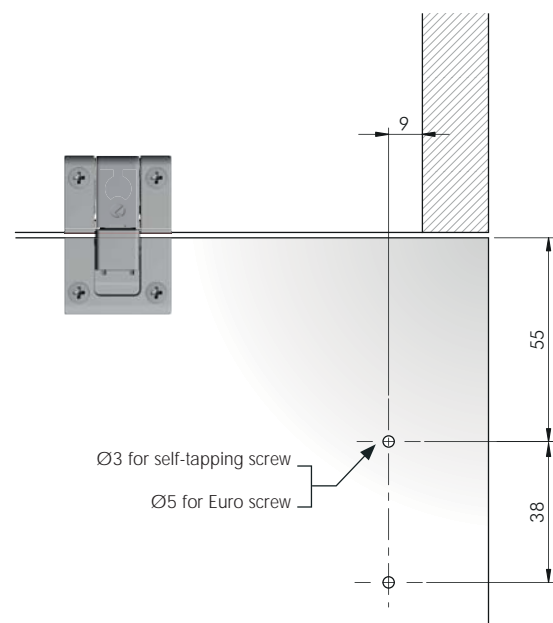

49503500YQ

EE

YQ

49503500YA

EW

YA

49503510YQ

LD

YQ

49503510YA

AB

YA

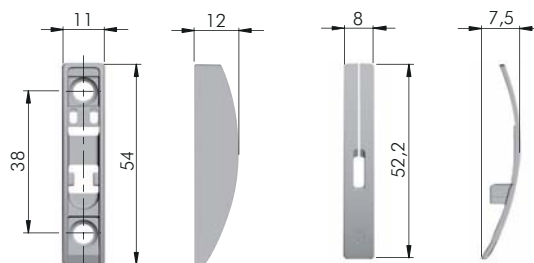



ACCESSORY FOR MECHANISM FIXING

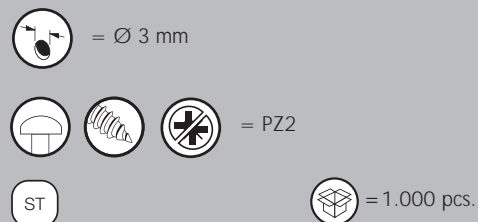
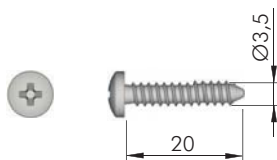

ACCESSORIES FOR DOOR BRACKET FIXING

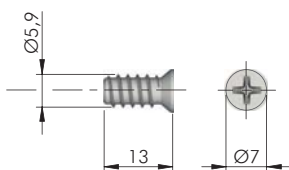
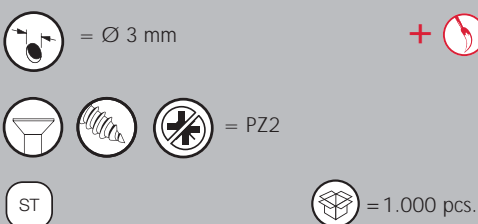
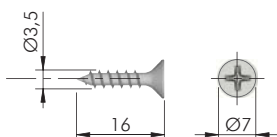



DOOR BRACKET ACCESSORY FOR DOORS WITH ALUMINIUM PROFILE



DOOR BRACKET INSTALLATION

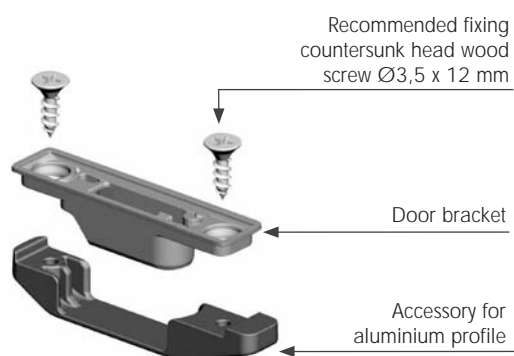

DOOR SPECIFICATION

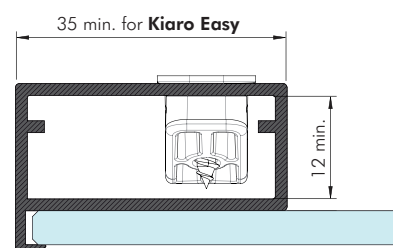

Join the door bracket with
the accessory keeping the
screws loose

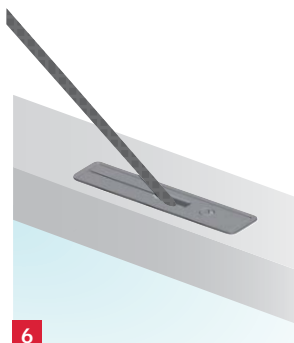
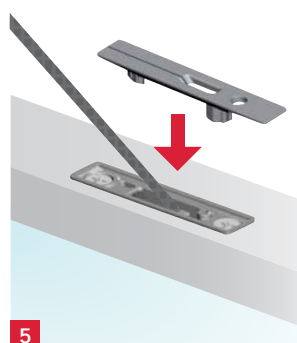
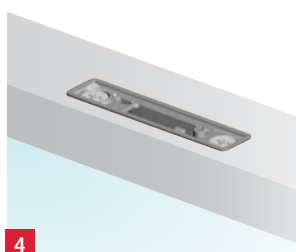
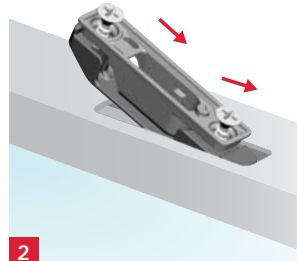
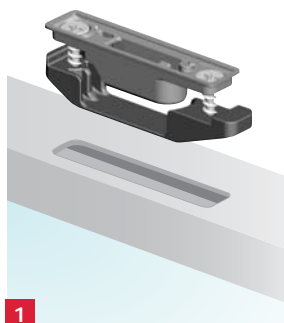

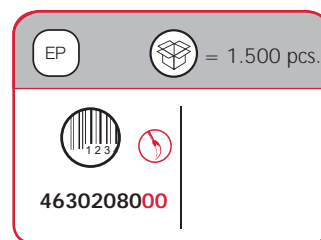
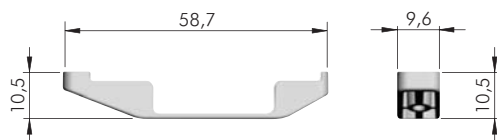

DRILLING PLAN FOR KIARO EASY

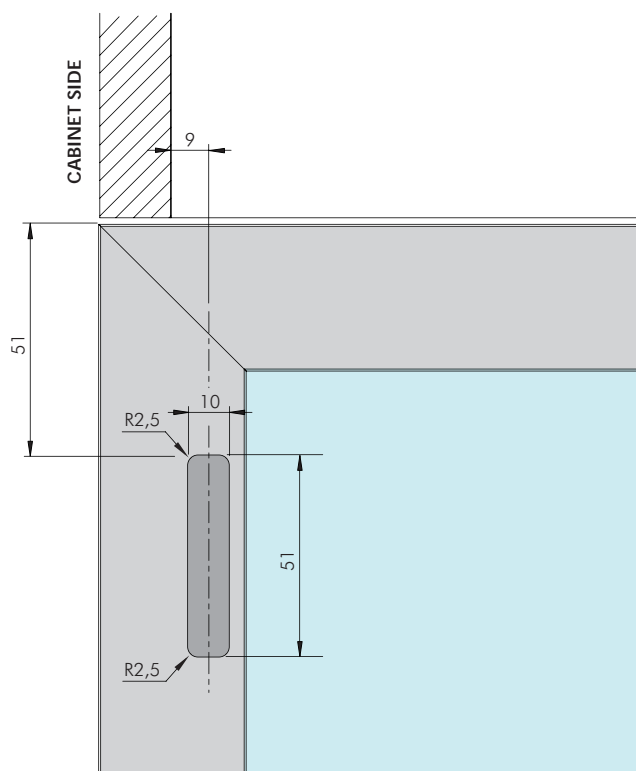

FIXING ACCESSORY

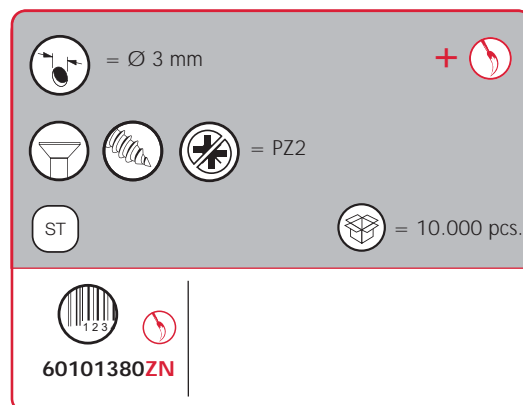
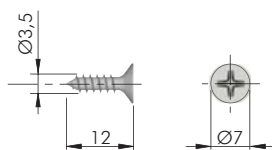



SYMBOLS AND FINISHES LEGEND

SYMBOLS

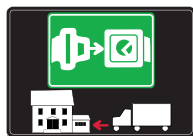

= SHELF SAFELY LOCKED DURING TRANSPORTATION AND AT HOME.



= ANTI-TURNOVER LOCKING SYSTEM



= NORMS / PATENTS



= PHILLIPS / POZIDRIV



= WITH BUFFER



= PART NO.



= BLADE SLOT



= WITH MAGNET



= PCS. PER PACKAGE



= COMBI SLOT



= HEXAGONAL SOCKET



= NEWTON



= CAPACITY LOADING



= HEXALOBULAR SOCKET



= FRICTION



= WOOD / GLASS THICKNESS



= COUNTERSUNK HEAD



= AUTOMATIC



= HOLE DIAMETER



= PAN HEAD



= DROP DOWN



= DIAMETER



= FLANGE HEAD



= LENGTH



= FLAT HEAD



= STANDARD HINGE



= HEIGHT



= TRILOBULAR SCREW



= KIMANA HINGE



= RIGHT VERSION



= SELF-TAPPING SCREW



= FLAP HINGE



= LEFT VERSION



= EURO THREAD



= WITH SPRING



= SETTING CODE



= METRIC THREAD



= WITHOUT SPRING



= PCS. PER PAD



= PRE-INSERTED SCREW



= REVERSED SPRING



= CUT ON REQUEST



= PRE-INSERTED SCREW AND SPREADING BUSH



= WITH FLANGE



= SELF ADHESIVE

NOTE: Printing errors and omissions may exist despite our best efforts to ensure accuracy. We reserve the right to alter specifications without notice.

MATERIALS

ZA = Zinc Alloy	ST = Steel	HSS = High Speed Steel	BR = Brass	ABS = Acrylonitrile Butadiene Styrene
ZAnk = Nickel-plated Zinc Alloy	STzk = Zinc-plated Steel	AL = Aluminium	WD = Wood	EVA = Ethylene Vinyl Acetate
EP = ENGINEERING PLASTIC		+ EP = other engineering plastic available on request		
		SR = SOFT RUBBER + SR = other soft rubber available on request		
EPn = Natural Engineering Plastic	EPc = Clear Engineering Plastic	SRn = Natural Soft Rubber		
EPw = White Engineering Plastic	EPg = Grey Engineering Plastic	SRw = White Soft Rubber		
EPb = Black Engineering Plastic	EPa = Anthracite Engineering Plastic	SRb = Black Soft Rubber		



FINISHES



+ = OTHER FINISHES AVAILABLE ON REQUEST

PART NO.	FINISHES	PART NO.	FINISHES	PART NO.	FINISHES
00	Insignificant finish	IF	Grey 7	XE	Inox
AA	Natural	IJ	Light Grey	YA	Nickel-plated
AB	White	IL	Grey 20	YC	Matt Nickel-plated
AE	White 9010	IN	Grey met. 26	YD	Satin-finished Nickel-plated
EA	Black	JG	Aluminium 5	YQ	Black Nickel
EC	Matt Black	JL	Aluminium PE 11	Z9	Black Zinc
EE	Anthracite	JM	Aluminium RAL 9006	ZN	Zinc-plated
EW	Grey 9007	KB	Bright Chrome	ZQ	Bright Gold
FU	Gunmetal	KC	Matt Chrome	ZZ	Clear/Transparent
FV	Gunmetal V52	LD	Brown 8019		
GR	Zamak Raw	RO	Red		
HA	Brass-Plated	UT	T-Met 9007		
HH	Tropicalized	UZ	T-Met		
HL	Raw Brass	WA	Bronzed		
HX	Graphite	WI	Burnished		
IA	Grey	XD	Satin-finished Steel		

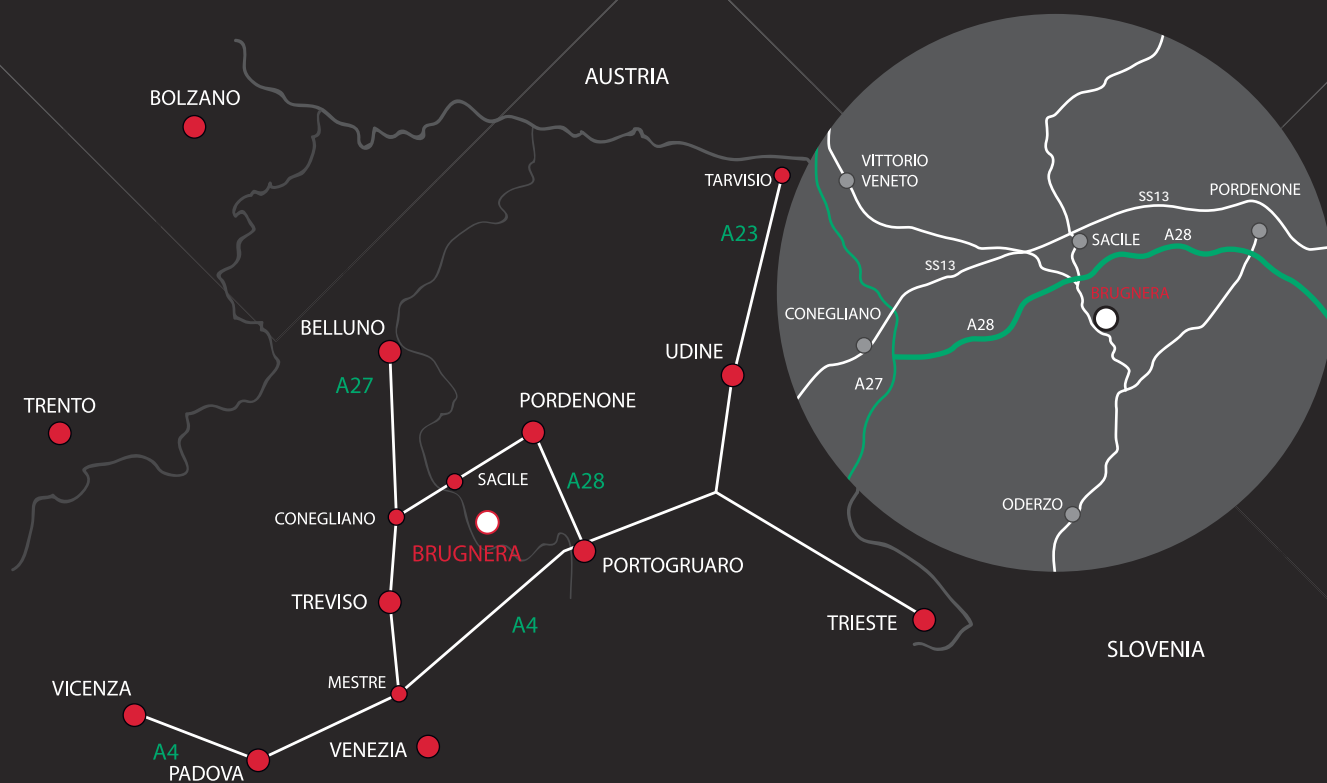

www.italianaferramenta.com

ITALIANA FERRAMENTA SRL - Viale Europa 17 I - 33070 Brugnara (PN)
 Tel. +39 0434 428211 Fax +39 0434 428242 E-mail: info@italianaferramenta.it